

Tube Removal Tools



Airetool PIC Internal Tube Cutters

The "PIC" internal tube cutters are an economical solution to low volume tube cutting of various tube materials. Optimum tube cutting performance and tooling life are obtained when the Airetool CF Series cutter feed assist is used to match the cutting speed to the tube material.

Available for tube sizes:

5/8" - 1-1/4" OD (15.8 - 31.8mm)

- Two-piece construction allows for quick and easy tool bit replacement.
- Cutter bits are now available with TiN coating, increasing the cutter bit life.
- Airetool PIC tube cutters are sold with a complete set of pilots and two spare tool bit sets.
- Larger sizes and longer reaches available upon request.



Tube O.D.		PIC Tube Cutter Reach*			Pilots (incl.)
(in.)	mm	Standard	"A"	"C"	(gauge)
1/2	12.70	PIC 500 (5519733)	PIC 500 A	PIC 500 C	18 - 20
5/8	15.88	PIC 625 (5515553)	PIC 625 A (5515557)	PIC 625 C (5515559)	16 - 20
3/4	19.05	PIC 750 (5515560)	PIC 750 A (5515540)	PIC 750 C (5515514)	14 - 20
7/8	22.22	PIC 875 (5515562)	PIC 875 A (5515564PT)	PIC 875 C (5515566PT)	15 - 20
1	25.4	PIC 1000 (5515567)	PIC 1000 A (5515568)	PIC 1000 C (5515554)	12 - 20
1-1/8	28.57	PIC 1125 (5515820)	PIC 1125 A	PIC 1125 C	14, 16, 18
1-1/4	31.75	PIC 1250 (5518134PT)	PIC 1250 A	PIC 1250 C	14, 16, 18

* Standard Reach = 1-11/16 to 4-7/16" (43 to 110mm)
 *A" Reach = 4-11/16 to 7-7/16" (119 to 189mm)
 *C" Reach = 8-3/16 to 10-15/16" (208 to 278mm)

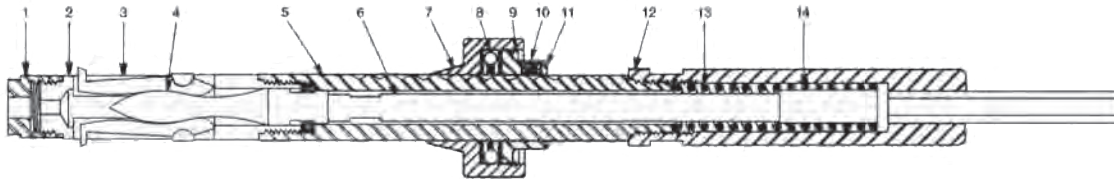

Item Number	Description	5/8" (16mm) 16-20GA	3/4" (19mm) 14-20GA	7/8" (22mm) 16-20GA	1" (25mm) 12-20GA
		Part No. (Order No.)	Part No. (Order No.)	Part No. (Order No.)	Part No. (Order No.)
	Complete PIC Cutter*	PIC-625 (5515553)	PIC-750 (5515560)	PIC-875 (5515562)	PIC-1000 (5515567)
1	Pilot	TTC-6 (2675000)	TTC-6-14 (2668900)	TTC-56-15 (2676400)	TTC-36-12 (2672500)
1	Pilot	TTC-46-18 (2675100)	TTC-6-15 (2669000)	TTC-56-16 (2990534)	TTC-36-13 (2672600)
1	Pilot	TTC-46-19 (2675200)	TTC-6-16 (2669100)	TTC-56-17 (2990535)	TTC-36-14 (2672700)
1	Pilot	TTC-46-20 (2675300)	TTC-6-17 (2669200)	TTC-56-18 (2676500)	TTC-36-15 (2672800)
1	Pilot	TTC-46-22 (2974902)	TTC-6-18 (2669300)	TTC-56-19 (2676600)	TTC-36-16 (2672900)
1	Pilot	TTC-46-23 (2976001)	TTC-6-19 (2669400)	TTC-56-20 (2676700)	TTC-36-17 (2673000)
1	Pilot	TTC-46-24 (2976002)	TTC-6-20 (2669500)		TTC-36-18 (2673100)
1	Pilot				TTC-36-19 (2673200)
1	Pilot				TTC-36-20 (2673300)
2	Body Tip	IC-41 (2979725)	IC-1 (2979306)	IC-51 (2979726)	IC-31 (2979419)
3	Tool Bit* (Non-ferrous)	TTC-43 (5338869)	TTC-3 (5338865)	TTC-53 (5338871)	TTC-33 (5338867)
3	Tool Bit* (Ferrous)	TTC-43-S (5338870)	TTC-3-S (5338866)	TTC-53-S (5338872)	TTC-33-S (5338868)
3	Tool Bit* (Stainless)	TTC-43-SS (5518303)	TTC-3-SS (5517614)	TTC-53-S (5517757)	TTC-33-SS (5516337)
4	Mandrel Tip	IC-44-T (2979724)	IC-4-T (2979308)	IC-34-T (2979409)	IC-34-T (2979409)
5	Body Extension	IC-41X (2979688)	IC-1X (2979672)	IC-51X (2979692)	IC-31X (2979680)
6	Mandrel Extension	IC-4X (2979676)	IC-4X (2979676)	IC-34X (2979684)	IC-34X (2979684)
7	Thrust Body	TTC-47 (2675400)	TTC-7 (2669600)	TTC-57 (2676800)	TTC-37 (2673300)
8	Bearing	TTC-9 (2670000)	TTC-9 (2670000)	TTC-39 (2673800)	TTC-39 (2673800)
9	Thrust Spring	TTC-10 (2670100)	TTC-10 (2670100)	TTC-40 (2673900)	TTC-40 (2673900)
10	Set Screw	10-32X1/4 (8000800)	10-32X1/4 (8000800)	10-32X1/4 (8000800)	10-32X1/4 (8000800)
11	Thrust Nut	TTC-48 (2675700)	TTC-8 (2669900)	TTC-58 (2677100)	TTC-38 (2673700)
12	Spring Housing	PIC-21 (2979752)	PIC-21 (2979752)	PIC-21 (2979752)	PIC-21 (2979752)
13	Spring	PTC-5 (2574180)	PTC-5 (2574180)	PTC-5 (2574180)	PTC-5 (2574180)
14	Driver	PIC-4 (2979751)	PIC-4 (2979751)	PIC-4 (2979751)	PIC-4 (2979751)

*Standard length listed